



**PULLMAN KUALA LUMPUR BANGSAR**



## Studio and Corporate Meeting Packages

**PULLMAN KUALA LUMPUR BANGSAR**  
**WE UNDERSTAND WORKING HARD IS OFTEN FOLLOWED BY PLAYING HARD**

**Studio Meeting Packages** inclusive of the below:

- Pullman Co-meetings three hour response guarantee for any meeting enquiries.
- Interactive kitchen with snacks, coffee & tea, fruit juices, fresh fruits available for morning and afternoon coffee breaks.
- International buffet lunch at Link Restaurant.
- Complimentary WIFI/Internet for all delegates.
- Complimentary use of studio meeting room from 9am until 5pm.
- Complimentary use of "Chill Out Space" for all meeting delegates.
- Complimentary usage of meeting amenities.

### TERMS & CONDITIONS

- Prior booking is required.
- Applicable for a minimum of 20 persons for meeting packages.

**Corporate Studio Meeting Packages** inclusive of the below:

- Two days one night stay in our contemporary Deluxe Rooms with buffet breakfast including free internet and WIFI in-room.
- Pullman Co-meetings three hour response guarantee for any meeting enquiries.
- Interactive kitchen with snacks, coffee & tea, fruit juices, fresh fruit available for morning and afternoon coffee breaks.
- International Buffet Lunch at Link Restaurant.
- Complimentary WIFI/Internet for all delegates.
- Complimentary use of studio meeting room from 9am until 5pm.
- Complimentary use of "Chill Out Space" for all meeting delegates.
- Complimentary usage of meeting amenities.

### TERMS & CONDITIONS

- Prior booking is required.
- Applicable for a minimum of 10 rooms.





## Dinner Packages

**PULLMAN KUALA LUMPUR BANGSAR BECAUSE PULLMAN KNOWS PARTIES**

**Dinner Packages** inclusive of the below:

- Special customised menu.
- Free flow of soft drink with tid-bits during pre-dinner & dinner.
- One complimentary Deluxe Room for one night stay.
- Free corkage for minimum of four barrels bought from the hotel.
- 25% discount on total bill for all guests after party at hotel's bar lounge - The Lounge.

### TERMS & CONDITIONS

- Prior booking is required.
- Applicable for a minimum of 15 tables with a minimum charge applied per person.
- Function rooms are allocated free of charge according to size of party.

To discover more, please contact our Event Manager



Call us at +6 (03)-2298 1888



Email us at [H7962@accor.com](mailto:H7962@accor.com)



**Level 1**  
Pullman Studio  
Executive Boardroom

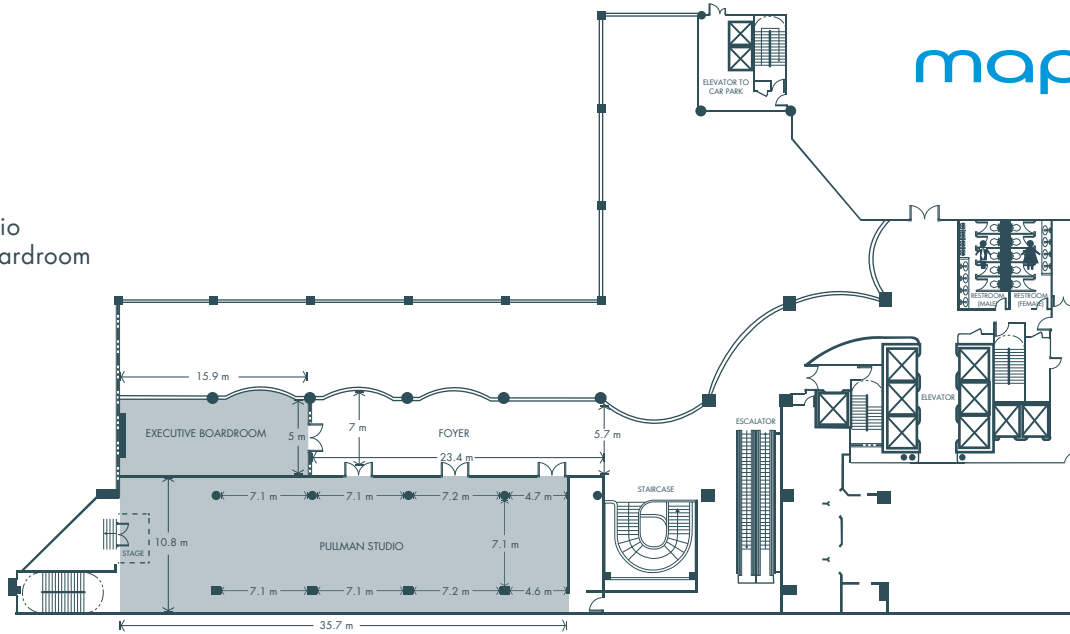

**Level 2**  
Pullman Grand Ballroom  
Pullman Ballroom 1  
Pullman Ballroom 2

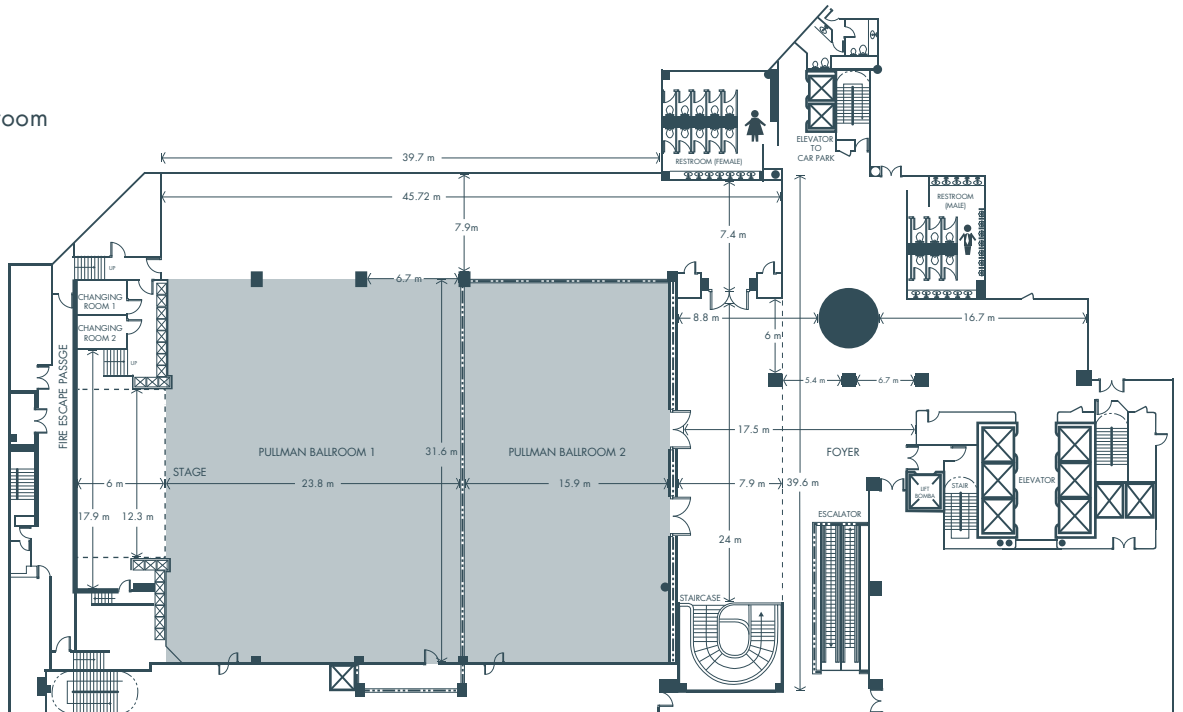



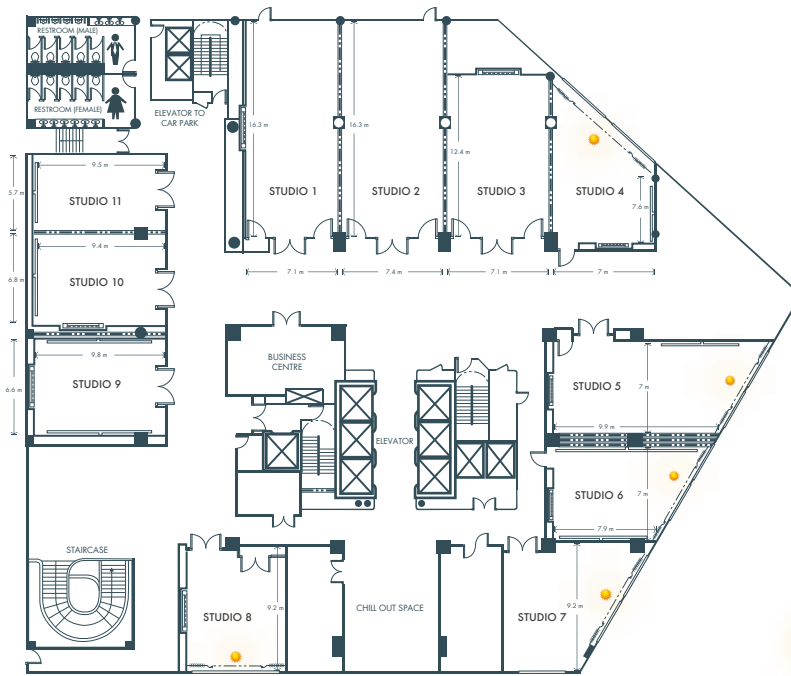





**Level 3**  
Studio 1  
Studio 2  
Studio 3  
Studio 4  
Studio 5  
Studio 6  
Studio 7  
Studio 8  
Studio 9  
Studio 10  
Studio 11

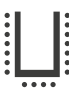

# PULLMAN KUALA LUMPUR BANGSAR

## Meeting Room and Banqueting Capacities

### Capacity of each layout

| Room name           |  Theatre |  U-Shape |  Boardroom |  Classroom |  Banquet |  Height |  Surface |  L x W(ft) |  Natural Day Light |
|---------------------|---|---|---|---|---|---|---|---|---|
| STUDIO 1            | 144   | 42  | 36  | 91  | 130   | 9ft   | 131 m <sup>2</sup>  | 52 x 28   | NO  |
| STUDIO 2            | 144   | 42  | 36  | 91  | 130   | 9ft   | 131 m <sup>2</sup>  | 52 x 28   | NO  |
| STUDIO 3            | 108   | 30  | 24  | 54  | 80  | 9ft   | 92 m <sup>2</sup>   | 41 x 25   | NO  |
| STUDIO 4            | 60  | 18  | 24  | 27  | 50  | 9ft   | 59 m <sup>2</sup>   | 46 x 25   | YES   |
| STUDIO 5            | 108   | 30  | 24  | 63  | 90  | 9ft   | 117 m <sup>2</sup>  | 46 x 25   | YES   |
| STUDIO 6            | 78  | 18  | 18  | 30  | 50  | 9ft   | 94 m <sup>2</sup>   | 30 x 26   | YES   |
| STUDIO 7            | 56  | 21  | 18  | 27  | 50  | 9ft   | 64 m <sup>2</sup>   | 26 x 20   | YES   |
| STUDIO 8            | 60  | 18  | 12  | 18  | 50  | 9ft   | 62 m <sup>2</sup>   | 21 x 24   | YES   |
| STUDIO 9            | 84  | 24  | 20  | 36  | 50  | 9ft   | 75 m <sup>2</sup>   | 31 x 27   | NO  |
| STUDIO 10           | 72  | 24  | 18  | 33  | 60  | 9ft   | 69 m <sup>2</sup>   | 31 x 24   | NO  |
| STUDIO 11           | 48  | 21  | 18  | 30  | 50  | 9ft   | 51 m <sup>2</sup>   | 31 x 18   | NO  |
| PULLMAN STUDIO      | 350   | -   | -   | 190   | 180   | 10ft  | 385 m <sup>2</sup>  | 119 x 23  | YES   |
| PULLMAN BALLROOM    | 1680  | -   | -   | 792   | 1320  | 27ft  | 1073 m <sup>2</sup>   | 129 x 123   | NO  |
| PULLMAN BALLROOM 1  | 900   | -   | -   | 576   | 540   | 27ft  | 599 m <sup>2</sup>  | 92 x 72   | NO  |
| PULLMAN BALLROOM 2  | 310   | -   | -   | 255   | 300   | 27ft  | 432 m <sup>2</sup>  | 92 x 52   | NO  |
| EXECUTIVE BOARDROOM | -   | -   | 22  | -   | -   | 10ft  | 86 m <sup>2</sup>   | 49 x 17   | NO  |



KUALA LUMPUR BANGSAR

**PULLMAN KUALA LUMPUR BANGSAR**

NO.1 JALAN PANTAI JAYA, TOWER 3 – KUALA LUMPUR 59200 – MALAYSIA  
T. +60 (3) 2298 1888 – F. +60 (3) 2298 1999 – H7962@ACCOR.COM  
PULLMANKUALALUMPUR.COM – PULLMANHOTELS.COM – ACCORHOTELS.COM